

FRONT ELEVATION

NOTE:
 - ELEVATIONS ARE FOR GRAPHIC REPRESENTATION ONLY. REFER TO WORK ORDER FORM FOR DETAILED INFORMATION.
 - EXTERIOR STEPS, RAILINGS & LANDINGS ONSITE BY OTHER.

<p>PROJECT NAME Franklin Ranch</p>		<p>FRONT ELEVATION</p>		<p>REVISIONS</p>				<p>KBS BUILDERS, INC.</p>									
<p>FILE NAME: SERIAL #:</p>		<p>SHEET # P2 SCALE: 3/16" = 1'-0" DWN BY: KBS DATE:</p>		<table border="1"> <tr><td> </td><td> </td></tr> <tr><td> </td><td> </td></tr> <tr><td> </td><td> </td></tr> <tr><td> </td><td> </td></tr> </table>										<p>300 PARK STREET, SOUTH PARIS, ME 04281 PHONE 207-739-2400 FAX 207-739-2723</p>			

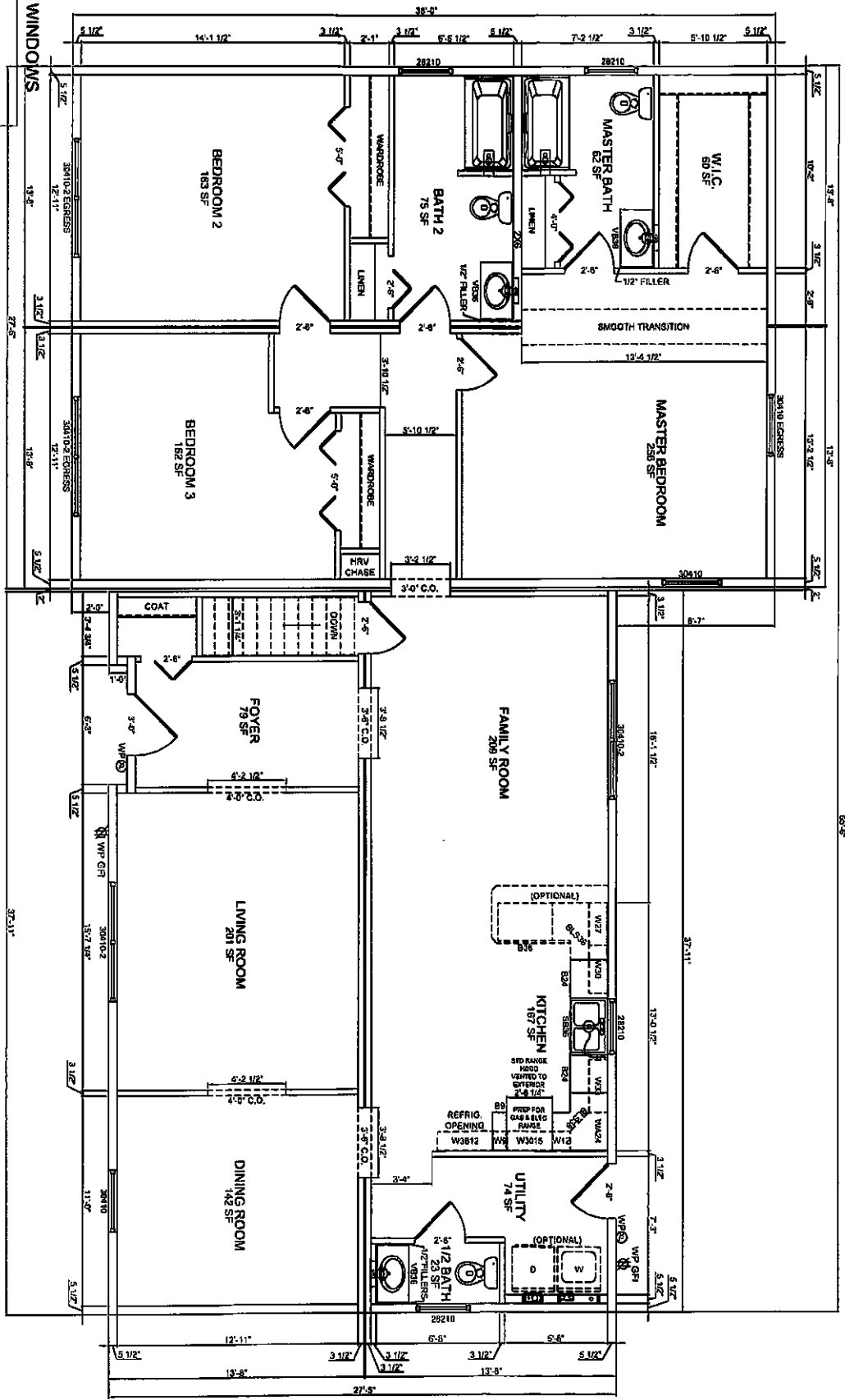

HARVEY WINDOWS
8'-0" CEILINGS

FRANKLIN RANCH
 FILE NAME: Franklin Ranch
 SERIAL #: [blank]

1ST FLOOR PLAN
 SHEET # P3
 SCALE: 3/16" = 1'-0"
 DWN BY: KBS
 DATE: [blank]

REVISIONS

NO.	DESCRIPTION



KBS BUILDERS, INC.
 300 PARK STREET, SOUTH PARS, ME 04281
 PHONE: 207-739-2400 FAX: 207-739-2223